

Wireless Networking

Wireless LAN

The Medical-Grade All-in-One Computer is often delivered with an embedded (user-inaccessible) 802.11 be WLAN adapter equipped with a hidden custom antenna.

- Through the support of typical WLAN adapters, the Medical-Grade All-in-One Computer should be able to detect all 802.11 access points in the vicinity for you to select the access point of your choice for connection.
- The SSID and WEP/WPA/WPA2 (if enabled) parameters on the Medical-Grade All-in-One Computer and the access points have to match. The SSID is case-sensitive and it is recommended that you enable WEP/WPA/WPA2 encryption (or advanced alternatives) for secure access.
- When WEP/WPA/WPA2 is enabled, you may need to consult your network administrator or your networking equipment literature to properly configure associated settings such as Authentication mode, etc.
- Refer to the access point operating manuals for setting up the 802.11 access points.

Cleaning the Screen

- A screen cleaning solution that is alcohol-free and non-abrasive can be used to clean the touchscreen.
- Cleaning with a micro-fiber cloth is recommended.
- Please spread the solution onto the cloth and then clean the touchscreen.

Cleaning the Anti-microbial Enclosure

- Use a soft/non-abrasive cloth moistened with water to clean the enclosure.
- If using a cleaner, an alcohol-free and oxide-free cleaning liquid is recommended.
- To prevent scratching the anti-microbial coating, please wipe gently.

DT Research

Medical-Grade All-in-One Computer

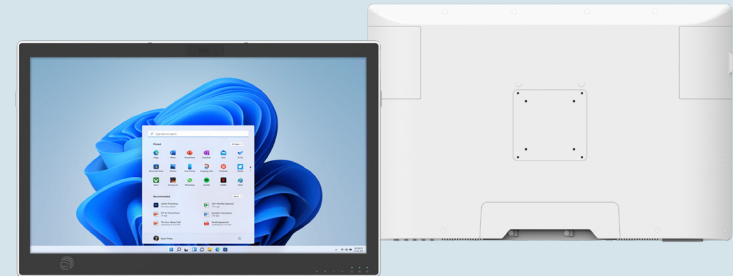

BASIC OPERATION GUIDE

DT574LA

INTRODUCTION

Thank you for acquiring DT Research's Medical-Grade All-in-One Computer. With a 23.8" Full HD touchscreen and powered by an Intel® Core™ Ultra processor, the Medical-Grade All-in-One Computer DT574LA offers an optimal functionality combining excellent performance and power-saving capability. With fully-integrated point-of-care modules within an elegant, space-saving enclosure, the Medical-Grade All-in-One Computer is ideal for patient data management, telemedicine, and point-of-care applications.

Please take a few moments to review the contents of this document to ensure that the setup and startup proceed smoothly. The Medical-Grade All-in-One Computer is ready for use, out of the box, in its default configuration when powered by the power source provided. The following documentation offers guidance on the hardware elements and features of the computer. Please refer to your device provider for information pertaining to the software operating system or software applications.

PACKAGE CONTENTS

- DT574LA
- AC-DC power adapter with power cord
- Basic operation guide

I/O Ports

The Medical-Grade All-in-One Computer has a comprehensive set of I/O ports located at the bottom side of the unit.

DT574LA

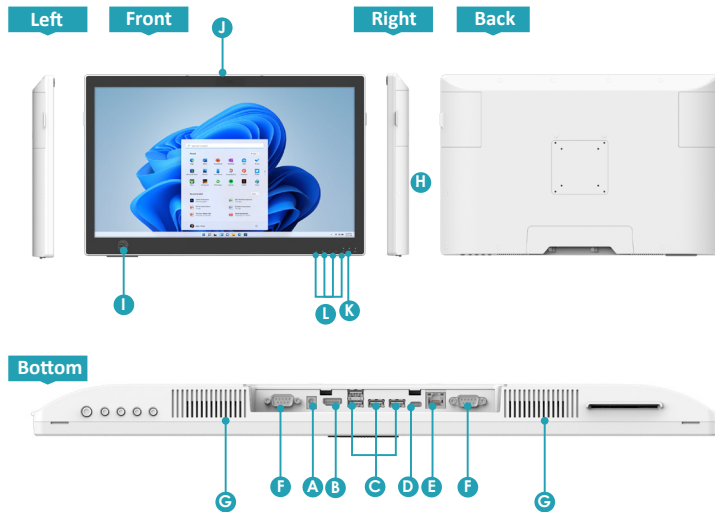

- | | |
|--------------------------------|---|
| A DC-in Jack | G Speakers |
| B HDMI output | H Smart card/CAC reader (optional) |
| C USB 3.2 ports | I RFID reader (optional) |
| D Latest USB/charging | J IR camera (optional) |
| E Ethernet ports (RJ45) | K Power |
| F COM ports | L Programmable buttons |

PRECAUTIONS

- Always exercise care when operating and handling the Medical-Grade All-in-One Computer.
- Never disassemble any portion of the enclosure, as this will void any product warranty on the Medical-Grade All-in-One Computer.
- Do not use any AC/DC adapter other than the one provided with the device or a replacement acquired from the manufacturer.
- In the unlikely event that smoke, abnormal noise or strange odor is present, immediately power down the Medical-Grade All-in-One Computer and disconnect all power sources. Please report the problem to your device provider immediately.

BASIC FEATURES

The Medical-Grade All-in-One Computer integrates a high-brightness 23.8" touchscreen with a high-performance system and USB ports to satisfy the varying needs for comprehensive point-of-care applications.

Powering ON and OFF

Please use the AC-DC adapter with the Medical-Grade All-in-One Computer for the power supply. To activate the Medical-Grade All-in-One Computer, push and quickly release the Power Button and the display will come on in a few seconds. To put in Standby mode, push and quickly release the Power Button. To turn off for extended storage, power off the device safely using any software function that "shuts down computer" provided in the software operating system.

NOTE:

To conserve power, use (push and quick release) the Power Button to put the device in "Standby" mode while not in use. Pushing briefly on the same button will wake up the system within seconds.

NOTE:

Avoid using the Power Button ("hold 4+ seconds" feature) to turn off the device — this form of hardware shutdown is intended to be a means of recovery from device lockups, and not as normal operation.