

DATA CAPTURE SPECIFICATIONS:

MSR	
Reference Standard	<ul style="list-style-type: none"> • ANSI/ISO Standards 7810, 7811-1/6, 7813 • JIS X6301, X6302 • AAMVA
Recording Method	Two-frequency coherent phase (F2F)
Decoding Method	ISO Track1 - IATA , Track2 - ABA and Track3 – THRIFT
Card Swiping Direction	Bi-directional
Card Swiping Speed	Card speed through the unit may vary from 3 ips to 100 ips (7 cm/s to 250 cm/s)
Life	Electronics: 125,000 hours; Head: 1,000,000 passes
RFID	
Frequency	13.56MHz ±7KHz
Modulate Mode	FSK
Reading Range	within 30mm depending on type of tags
HF RFID Reader	ISO 15693, 14443A, 14443B, Felica UID
Barcode Scanner (1D)	
Decoded Mode	UPC (E&A), EAN, RSS, Code 39, Code 128, UCC/EAN 128, ISBN, ISBT, Interleaved, Matrix, Industrial and Standard 2 of 5, Codabar, Code 93/93i, Code 11, MSI, Plessey, Telepen, PDF417, Macro PDF417
Scan Rate	Decoded Operation: up to 500 scans per second (auto-adaptive) Standard and Emulated: DBP 200 scans per second
Scan Angle	Scan angle: 40°; Skew: 65°; Pitch: 75°; Tilt: 25° (N/A on stacked codes)
Reading Distance	0 to 90 cm / 35.4 in
Ambient Light	Works in any lighting conditions from 0 to 100,000 lux
Barcode Scanner (2D)	
Decode Mode	1D symbologies: EAN/UPC, RSS, Code 39, Code 128, UCC/EAN 128, ISBN, ISBT, Interleaved, Matrix, Industrial and Standard 2 of 5, Codabar, Code 93/93i, Code 11, MSI, Plessey, Telepen, postal codes. 2D symbologies: Data Matrix, PDF417, Micro PDF 417, Maxicode, QR, Aztec, EAN.UCC composite
Scan Rate	2D mode: 56 images per second, auto adaptive Linear emulation mode: 200 images per second, auto adaptive
Scan Angle	Horizontal: 38.9°; Vertical: 25.4°
Optical Resolution	752 (H) x 480 (V) pixels, 256 gray levels
Print Contrast	Down to 25%
Versions	Standard range and high density

* Specifications subject to change without notice.

DT430

BASIC OPERATION GUIDE

ENGLISH



INTRODUCTION

Thank you for acquiring the DT430, part of the POS Handheld line. The DT430 offers a 4.3" outdoor-viewable display, in a compact, rugged, and lightweight package. The DT430 enables efficient point-of-service applications, inventory management, and field services. IP54 rated for water and dust resistance with IP65 sealed front panel, the WebDT430 performs indoors, outdoors, and in harsh environments.

The WebDT Point-of-Service Handheld provides the precise features needed to streamline operations and improve productivity, data accuracy, and service.

PACKAGE CONTENTS

1. One DT430
2. One battery pack
3. Basic operation guide
4. Stylus lanyard and hand strap

* The actual package contents may vary depending on the configuration acquired.

PRECAUTIONS

- Always exercise care when operating and handling the DT430.
- Do not disassemble any portion of the DT430. It will void any product warranty on DT430.
- Do not use any power adapter or charging cradle other than the one provided with the device or acquired from the manufacturer or its partners.
- In the unlikely event that abnormal noise, strange odor, or smoke is present, immediately power down the DT430 and disconnect all power sources. Please report the problem to your device provider immediately.

DT430

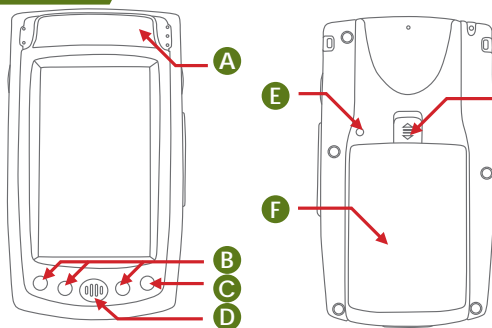

- A Magnetic Stripe Reader
- B Programmable buttons
- C Suspend/ Resume
- D Speaker
- E Power button
- F Battery
- G Battery pack switch

Button Functions

- Enable/ disable soft keyboard (Programmable)
- Programmable
- System Utility
- Suspend/ Resume
- Hold + press Touch screen calibration

DT430 I/O Ports

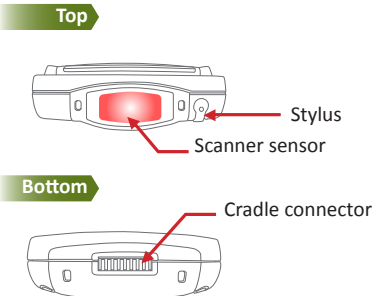
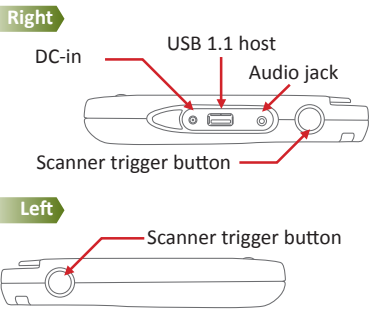

DT430 LED Status Indicators

- 1. Power Mode Status Indicator:**
 - Blue: Device is powered on
 - Blinking Blue: Main battery charging
 - Orange: Low battery mode
 - Blinking Orange: Extremely low battery mode
 - Off: Device is powered off or in suspend mode
- 2. Wi-Fi Status Indicator:**
 - Blue: The device has been connected to a wireless AP
 - Blinking blue: The device is connecting to a wireless AP
 - Off: Wi-Fi is disabled
- 3. Magnetic Stripe Reader Indicator:**
 - Power On – Powering on Sequence: blinks orange 2 times, then lights solid blue
 - Ready – Solid blue
 - Read Ok – Blinks blue 1 time
 - Read Error – Orange and then turn to blue



ACCESSORIES:



- Charging Cradle PN: ACC-400-01**
Desktop cradle with rear pocket battery charger and data synchronization with PC via USB port.
Input: 100 - 240V AC; output: 5V DC, 3A.
- 4-bay Gang Charger PN: ACC-400-02**
Wall mountable charger, capable of charging up to 4 handhelds simultaneously.
- AC-DC Adapter PN: ACC-400-03**
Used to charge handheld battery, and pass through power for charging cradle.
- Battery PN: ACC-400-04**
Hot-swappable, rechargeable Li-Ion battery 3800mAh, 3.7V (14 Watt-hour).
- Trigger Grip PN: ACC-400-05**
For single hand operation to trigger scanner or other functions conveniently.

SPECIFICATIONS

System	
Processor	ARM 533 MHz
Memory (RAM)	128MB DDR II, 128MB Flash ROM
Operating System	Microsoft® Windows® CE 6.0 or Windows® Mobile 6
Display	4.3" TFT-LCD with resistive touch; outdoor-viewable display
Display Resolution	272 x 480 (WQVGA)
Network Interface	Built-in IEEE 802.11b/g WLAN, Bluetooth 2.1 with EDR
Control Switch and Buttons	1 power button; 4 front buttons; 2 trigger buttons
Indicator	1 power-on LED indicator, 1 WLAN enable/ communication indicator, 1 MSR indicator
Speaker/ Microphone	Built-in speakers; 1 mono microphone
Input/Output Ports	1 headset jack, 1 USB 1.1 host, 1 cradle interface (USB2.0 and charging), 1 DC-in jack
Power	
AC/DC Adapter	Input: 100 – 240V AC; Output: 5V DC, 3A
Backup Battery	180 mAh
Battery Type	Li-ion battery 3760 mAh, 3.7V
Mechanical	
Enclosure	PC+ABS, TPR
Stylus	Non-electronic tip
Dimensions (H x W x D)	6.3 x 3.4 x 1.2 in/ 160 x 86 x 30 mm
Weight	0.9 lbs/ 415 g
Environmental	
Regulatory	FCC Class B, CE, C-Tick, RoHS compliant
Water and Dust Resistance	System: IP54; Front Panel: IP65
Operating Temperature	Operation: 0°C - 40°C; Storage: -20°C - 60°C
Humidity	0% - 90% non-condensing

* Specifications subject to change without notice.