

## Wireless Networking

### Wireless LAN

The Medical-Grade All-in-One Computer is often delivered with an embedded (user-inaccessible) 802.11 ax WLAN adapter equipped with a hidden custom antenna.

- Through the support of typical WLAN adapters, the Medical-Grade All-in-One Computer should be able to detect all 802.11 access points in the vicinity for you to select the access point of your choice for connection.
- The SSID and WPA/WPA2/WPA3 (if enabled) parameters on the Medical-Grade All-in-One Computer and the access points have to match. The SSID is case-sensitive and it is recommended that you enable WPA/WPA2/WPA3 encryption (or advanced alternatives) for secure access.
- When WPA/WPA2/WPA3 is enabled, you may need to consult your network administrator or your networking equipment literature to properly configure associated settings such as Authentication mode, etc.
- Refer to the access point operating manuals for setting up the 802.11 access points.

### Cleaning the Screen

- A screen cleaning solution that is alcohol-free and non-abrasive can be used to clean the touchscreen.
- Cleaning with a micro-fiber cloth is recommended.
- Please spread the solution onto the cloth and then clean the touchscreen.

### Cleaning the Anti-microbial Enclosure

- Use a soft/non-abrasive cloth moistened with water to clean the enclosure.
- If using a cleaner, an alcohol-free and oxide-free cleaning liquid is recommended.
- To prevent scratching the anti-microbial coating, please wipe gently.



As an ENERGY STAR® Partner, DT Research Inc. follows the EPA's product qualification and certification process to ensure the products marked with the ENERGY STAR® logo are ENERGY STAR® qualified for energy efficiency.

The ENERGY STAR® program specifications for computers were to promote energy efficiency and reduce air pollution through more energy-efficient equipment in homes, offices, and factories. One way products achieve this goal is by using the Microsoft Windows power management feature to reduce power consumption when the product is not in use. The power management feature enables the computer to initiate a low-power or "sleep" mode after a period of user inactivity.

To take advantage of these potential energy savings, users should use the default power management settings that are provided with ENERGY STAR qualified computers. The default power management settings on ENERGY STAR® qualified computers are preset to behave in the following ways :

- Turn off display after 10 minutes of user inactivity.
- Initiate a low power sleep mode for the computer after 30 minutes of user inactivity.
- Briefly press the power button will bring the computer out of sleep mode.

Additional information on the ENERGY STAR® program, its environmental benefits and the potential energy and financial savings of the power management feature can be found on the EPA ENERGY STAR® Power Management Web site at <http://www.energystar.gov/powermanagement>.

# DT Research

## Medical-Grade All-in-One Computer



## BASIC OPERATION GUIDE

# DA573LF

## INTRODUCTION

Thank you for acquiring DT Research's Medical-Grade All-in-One Computer. Featuring a 17.3" multi-touch display, the DA573LF is powered by a Qualcomm® Octa-core processor and runs on the Android™ 14 platform, offering a seamless and responsive user experience. With its energy-efficient design and fully-integrated point-of-care modules, this computer is an ideal solution for patient data management, telemedicine, and clinical applications.

Please take a few moments to review this document to ensure a smooth setup and startup. The device is ready for use out-of-the-box in its default configuration when powered by the provided power source. The following documentation provides guidance on hardware elements and features; for information regarding specific software applications or system settings, please refer to your software provider.

## PACKAGE CONTENTS

- DA573LF
- AC-DC power adapter with power cord
- Basic operation guide

## I/O Ports

The Medical-Grade All-in-One Computer has a comprehensive set of I/O ports located at the bottom side of the unit.

### DA573LF

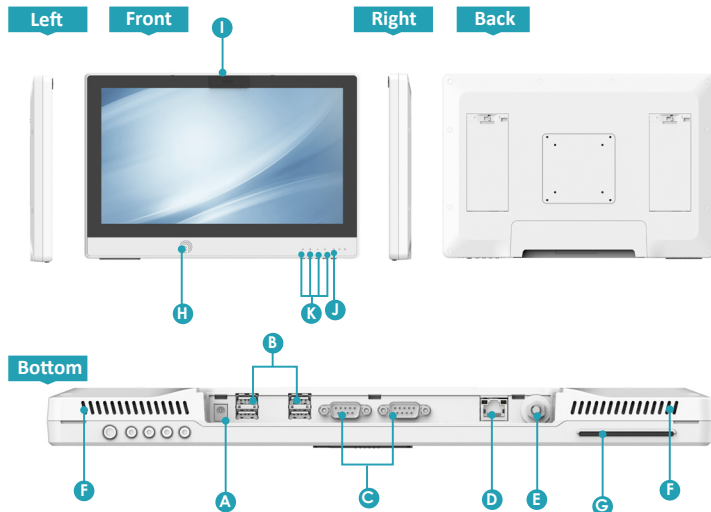

- |                               |   |
|-------------------------------|---|
| <b>A</b> DC-in Jack           | <b>G</b> Smart card/CAC reader (optional) |
| <b>B</b> USB 3.2 ports        | <b>H</b> NFC/RFID reader (optional)       |
| <b>C</b> COM ports            | <b>I</b> Front camera (optional)          |
| <b>D</b> Ethernet port (RJ45) | <b>J</b> Power                            |
| <b>E</b> POAG (optional)      | <b>K</b> Programmable buttons             |
| <b>F</b> Speakers             |   |

## PRECAUTIONS

- Always exercise care when operating and handling the Medical-Grade All-in-One Computer.
- Never disassemble any portion of the enclosure, as this will void any product warranty on the Medical-Grade All-in-One Computer.
- Do not use any AC/DC adapter other than the one provided with the device or a replacement acquired from the manufacturer.
- In the unlikely event that smoke, abnormal noise or strange odor is present, immediately power down the Medical-Grade All-in-One Computer and disconnect all power sources. Please report the problem to your device provider immediately.

## BASIC FEATURES

The Medical-Grade All-in-One Computer integrates a high brightness 17.3" touchscreen with a high-performance system and USB ports to satisfy the varying needs for comprehensive point-of-care applications.

### Powering ON and OFF

Please use the AC-DC adapter with the Medical-Grade All-in-One Computer for the power supply. To activate the Medical-Grade All-in-One Computer, push and quickly release the Power Button and the display will come on in a few seconds. To put in Standby mode, push and quickly release the Power Button. To turn off for extended storage, power off the device safely using any software function that "shuts down computer" provided in the software operating system.

#### NOTE:

To conserve power, use (push and quick release) the Power Button to put the device in "Standby" mode while not in use. Pushing briefly on the same button will wake up the system within seconds.

#### NOTE:

Avoid using the Power Button ("hold 4+ seconds" feature) to turn off the device — this form of hardware shutdown is intended to be a means of recovery from device lockups, and not as normal operation.